

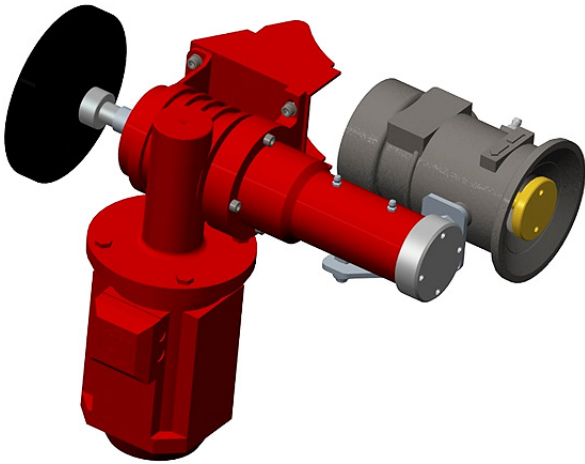

Monitor Equipment | Monitor Discharge Devices | EFX-AX Nozzle for Remote Controlled Monitor  
Electric Adjustable Nozzle | ATEX Area



- Remote adjustment from full jet through to full fog / water curtain
- Manual override adjustment
- Refer to technical documentation for full list of features, monitors and control panels

SPECIFICATIONS	
Related Documents	RFQ / order checklist Technical data page (pending)
Approvals / Certifications	   
Finish	Natural
Monitor Quantity	1 or 2 monitors
Ingress Protection	IP66
Connection	BSP threaded
Working pressure	12 bar (max)
Power Requirement	3 Phase 400VAC 0.18kW
Installation Area	ATEX area
Options	Safe area version available

Model	Maximum Flow	Material	Thread	Part Number
EFX25	3,000l/min @7 bar	Anodized Aluminium	3" BSP	EFX25-AL-3-AX
		Nickel Aluminium Bronze	3" BSP	EFX25-NAB-3-AX
EFX30	3,500l/min @7 bar	Stainless Steel 316	3" BSP	EFX30-SS-3-AX
EFX45	4,500l/min @7 bar		3" BSP	EFX45-SS-3-AX
		4" BSP	EFX45-SS-4-AX	
EFX60	6,500l/min @7 bar	Stainless Steel 316	4" BSP	EFX60-SS-4-AX

Note: This document contains basic product information only. Information, photos and drawings are not contractually binding. In all cases, the manufacturer's full technical documentation (see "Related Documents" above) remains the reference document. Note that certificates, test reports and approvals may be published in the OEM name. The contents of this publication are subject to modifications without notice. All rights reserved.

Trusted above all.

