





Monitor Equipment | Manual Monitor | ML2 Lever Operated Monitor



SPECIFICATIONS	
Related documents	None available
Approvals	  
Material (Body)	Nickel aluminium bronze
Material (Joints)	Nickel aluminium bronze with stainless steel AISI 316 balls
Material (Flange)	Carbon steel or stainless steel or nickel aluminium bronze
Working pressure	16 bar* (Max.)
Finish	Natural or red epoxy (Flame red RAL3000)
Connection type	Flange PN16
Rotation	360° continuous
Swivels	Vertical (Lever) Horizontal (Knob)
Options	<ul style="list-style-type: none"> ANSI flanges Brass automatic drain valve
Weight	See table
<p>* Note: Lower working pressures may need to be assessed based upon how the monitor is operated, supported and where installed. Please refer to recoil force table for further information.</p>	

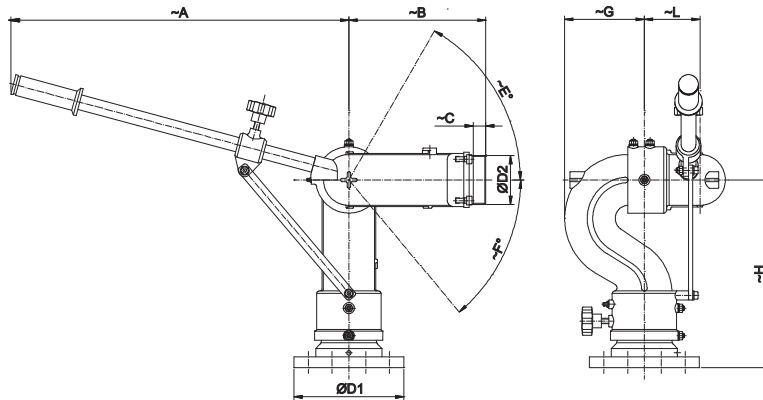

Part number	A (mm)	B (mm)	C (mm)	ØD1 (inch) PN16	Flange material	ØD2 (inch) BSP	E (°)	F (°)	G (mm)	H (mm)	L (mm)	Max. flow rate (l/min)	Weight (kg)
3" nickel aluminium bronze body - Natural finish													
EML2-LB-3X3CPN	615	249	23	3"	Carbon steel	3"	80	50	145	340	101	4,000	29.0
EML2-LB-3X3SPN	615	249	23	3"	Stainless steel	3"	80	50	145	340	101	4,000	29.0
EML2-LB-3X4SPN	615	249	23	4"	Stainless steel	3"	80	50	145	340	101	4,000	30.0
EML2-LB-3X4LBPN	615	249	23	4"	Nickel aluminium bronze	3"	80	50	145	340	101	4,000	30.0
3" nickel aluminium bronze body - Red epoxy (Flame red RAL3000) finish													
EML2-LB-3X3CPP	615	249	23	3"	Carbon steel	3"	80	50	145	340	101	4,000	29.0
EML2-LB-3X3SPP	615	249	23	3"	Stainless steel	3"	80	50	145	340	101	4,000	29.0
EML2-LB-3X4SPP	615	249	23	4"	Stainless steel	3"	80	50	145	340	101	4,000	30.0
EML2-LB-3X4LBPP	615	249	23	4"	Nickel aluminium bronze	3"	80	50	145	340	101	4,000	30.0

Note: This document contains basic product information only. Information, photos and drawings are not contractually binding. In all cases, the manufacturer's full technical documentation (see "Related Documents" above) remains the reference document. Note that certificates, test reports and approvals may be published in the OEM name. The contents of this publication are subject to modifications without notice. All rights reserved

Trusted above all.

